

# SHIMANO

## ANTARES SA-RB

## ANT-HGL

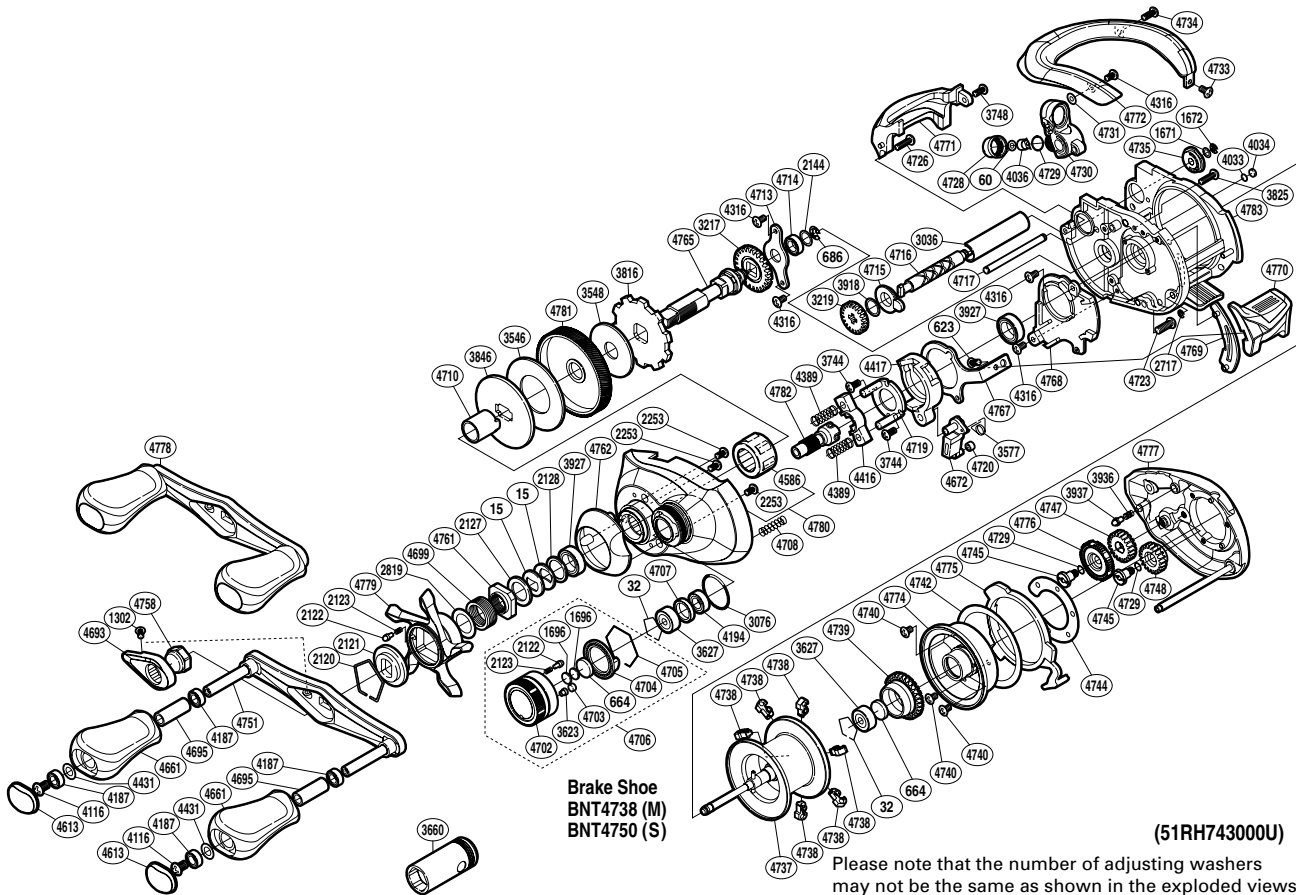

Brake Shoe  
BNT4738 (M)  
BNT4750 (S)

(51RH743000U)

Please note that the number of adjusting washers may not be the same as shown in the exploded views. (Adjustment will vary with each individual product.)

| Part No. | Description               | Part No. | Description               | Part No. | Description              |
|----------|---------------------------|----------|---------------------------|----------|--------------------------|
| BNT0015  | Drag Spring Washer        | BNT4033  | Washer                    | BNT4731  | Spacer                   |
| BNT0032  | Bearing Retainer          | BNT4034  | Anti-Thrust Washer        | BNT4733  | Screw                    |
| BNT0060  | Spacer                    | BNT4036  | Line Guide Pawl           | BNT4734  | Screw                    |
| BNT0623  | Screw                     | BNT4116  | Screw                     | BNT4735  | Worm Bushing B           |
| BNT0664  | Spacer B                  | BNT4187  | Ball Bearing              | BNT4737  | Spool Assembly           |
| BNT0686  | E Lock                    | BNT4194  | Ball Bearing              | BNT4738  | Brake Shoe M             |
| BNT1302  | Screw                     | BNT4316  | Screw                     | BNT4739  | Brake Ring Gear          |
| BNT1671  | Washer                    | BNT4389  | Yoke Spring               | BNT4740  | Screw                    |
| BNT1672  | E Lock                    | BNT4416  | Yoke                      | BNT4742  | Washer                   |
| BNT1696  | Cast Control Spacer       | BNT4417  | Clutch Cam                | BNT4744  | Brake Case Washer        |
| BNT2120  | Click Plate Retainer      | BNT4431  | Washer                    | BNT4745  | Screw                    |
| BNT2121  | Star Drag Click           | BNT4586  | Roller Clutch Bearing     | BNT4747  | BR Dial Gear             |
| BNT2122  | Click Pin                 | BNT4613  | Handle Knob Seal          | BNT4748  | Idle Gear                |
| BNT2123  | Click Spring              | BNT4661  | Handle Knob               | BNT4751  | Handle Shank Assembly    |
| BNT2127  | Star Drag Spacer          | BNT4672  | Clutch Pawl               | BNT4758  | Handle Nut               |
| BNT2128  | Bearing Washer            | BNT4693  | Handle Nut Plate          | BNT4761  | Star Drag Nut            |
| BNT2144  | Washer                    | BNT4695  | Handle Knob Pipe          | BNT4762  | Clutch Button Attachment |
| BNT2253  | Screw                     | BNT4699  | Star Drag Spring          | BNT4765  | Drive Shaft              |
| BNT2717  | E Lock                    | BNT4702  | Cast Control Cap          | BNT4767  | Clutch Plate             |
| BNT2819  | Washer                    | BNT4703  | Retainer Sheet            | BNT4768  | Clutch Guard             |
| BNT3036  | Level Wind Guard          | BNT4704  | Cast Control Click Plate  | BNT4769  | Clutch Bar Guide B       |
| BNT3076  | O Ring                    | BNT4705  | Cast Control Click Holder | BNT4770  | Quick-Fire II Clutch Bar |
| BNT3217  | Idle Gear                 | BNT4706  | Cast Control Cap Assembly | BNT4771  | Level Wind Protector     |
| BNT3219  | Idle Gear                 | BNT4707  | Bearing Spacer            | BNT4772  | Thumb Rest               |
| BNT3546  | Drag Washer               | BNT4708  | Damper Spring             | BNT4774  | Brake Case               |
| BNT3548  | Drag Washer               | BNT4710  | Roller Clutch Inner Tube  | BNT4775  | Side Plate Cam Lever     |
| BNT3577  | Clutch Pawl Spring        | BNT4713  | Drive Shaft Retainer      | BNT4776  | BR Dial                  |
| BNT3623  | Cast Control Cap Retainer | BNT4714  | Ball Bearing              | BNT4777  | Right Side Plate         |
| BNT3627  | Ball Bearing              | BNT4715  | Worm Bushing A            | BNT4778  | Handle Assembly          |
| BNT3744  | Screw                     | BNT4716  | Worm Shaft                | BNT4779  | Star Drag                |
| BNT3748  | Screw                     | BNT4717  | Stabilizer Bar            | BNT4780  | Left Side Plate          |
| BNT3816  | Anti-Reverse Ratchet      | BNT4719  | Clutch Cam Retainer       | BNT4781  | Drive Gear               |
| BNT3825  | Screw                     | BNT4720  | Clutch Pawl Bushing       | BNT4782  | Pinion Gear              |
| BNT3846  | Key Washer                | BNT4723  | Screw                     | BNT4783  | One-Piece Frame          |
| BNT3918  | Washer                    | BNT4726  | Screw                     |          |                          |
| BNT3927  | Ball Bearing              | BNT4728  | Pawl Cap                  | BNT3660  | Reel Wrench (accessory)  |
| BNT3936  | Click Spring              | BNT4729  | O Ring                    | BNT4692  | B-100 Oil (accessory)    |
| BNT3937  | Click Pin                 | BNT4730  | Line Guide                | BNT4750  | Brake Shoe S (accessory) |